

Location Plan, Scale: 1:1,250

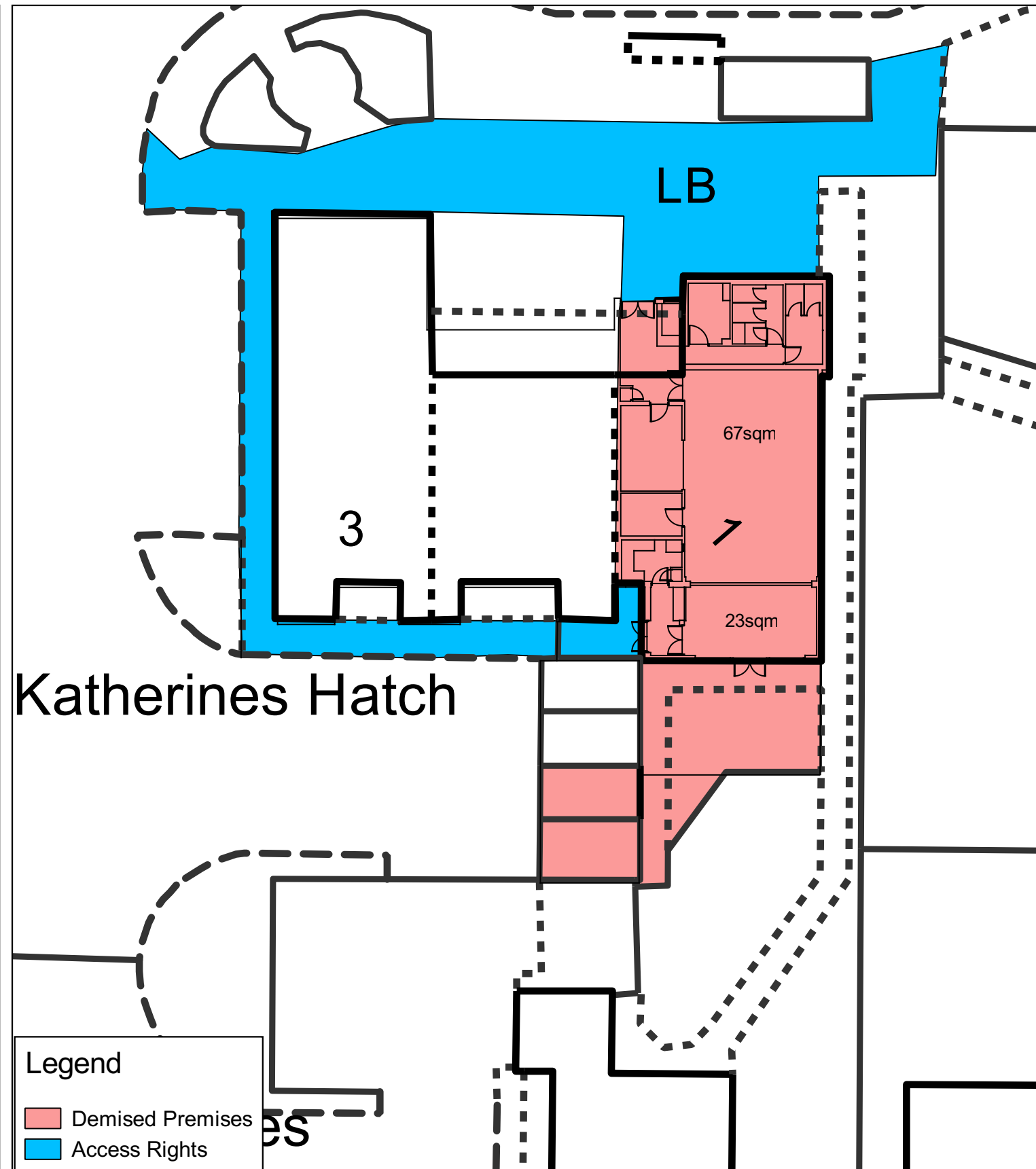

# Katherines Hatch

**Legend**

- Demised Premises
- Access Rights

Detail Plan, Scale: 1:250



**Katherines Hatch Common Room**  
 Brookside  
 Harlow  
 Essex

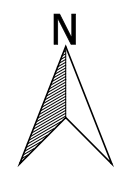

Harlow Council Civic Centre The Water Gardens Harlow Essex, CM20 1WG Tel. 01279 446655 Email. <a href="mailto:contact@harlow.gov.uk">contact@harlow.gov.uk</a>	Scale: 1:250 , 1:1,250	Date: 15/11/2018	Drawn By: Miroslav Sihelsky	Drawing Number: GIM4308-069A
--	---------------------------	---------------------	--------------------------------	---------------------------------

This map is based upon Ordnance Survey material with the permission of Ordnance Survey on behalf of the Controller of Her Majesty's Stationery Office © Crown copyright. Unauthorised reproduction infringes Crown copyright and may lead to prosecution or civil proceedings. Harlow District Council Licence No.100019627 (2018)